

ORDER FORM

Badger Defense, LLC.

8330 -196th Avenue
PO Box 417
Bristol, WI 53104-0417

Phone 262-857-6950
FAX 262-857-6988

If you would like to place an order, print out this page and mail or fax it to us at the above address or fax number. We do not take orders over the Internet. To assist us in designing your barrels, we will need the following information. If you have any questions, feel free to call us, and we will assist you in filling out the form.

1. Circle type of contour desired – full octagon with “rosette,” full octagon no rosette, round-straight taper, round-contour taper, fluted, ½ octagon with rosette, ½ octagon no rosette, rough blank
2. Caliber and twist desired _____
3. Type of material desired – chromemoly OR stainless steel
4. Finished barrel length _____
5. If barrel is to be round at receiver end, what diameter? _____
6. If barrel is to have a round area over the chamber, what distance is it to be from the face of the receiver to where octagon is to start? _____
7. Barrel diameter across the flats (or round) at the receiver end? _____
8. Barrel diameter across the flats (or round) at the muzzle end? _____
9. To assist us in determining barrel shank length to be left for threading, indicate receiver type, if possible _____
10. Feel free to attach a rough drawing with dimensions to assist us with your order. We need to know dimensions on ½ octagons (length of octagon – see drawings), or how long flutes are and how far from muzzle, etc. Please use “drawing page” to fill in the dimensions.

Please print this order form out, fill in the information, and mail or fax it to us. If we have any questions, we will call you. **Thank you.**

Your name _____

Address (shipping) _____ (Bus or res.)

City, ST ZIP (shipping) _____

Address (billing) _____

City, ST ZIP (billing) _____

Phone _____ FAX _____

Number of barrels requested _____

Date of order _____

Barrel "D"
like Sharps
full octagon
barrel

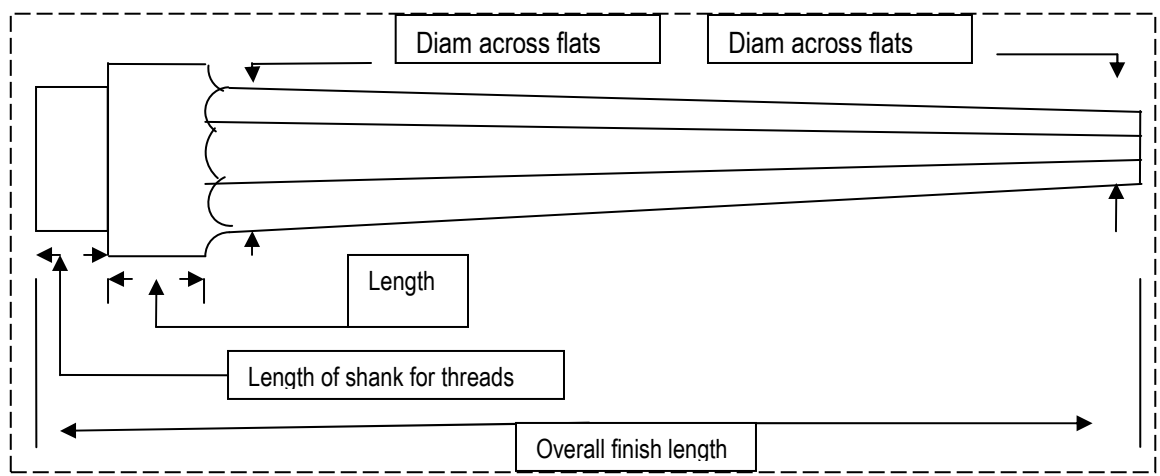

Barrel "D/C"
like Sharps 1/2
octagon barrel

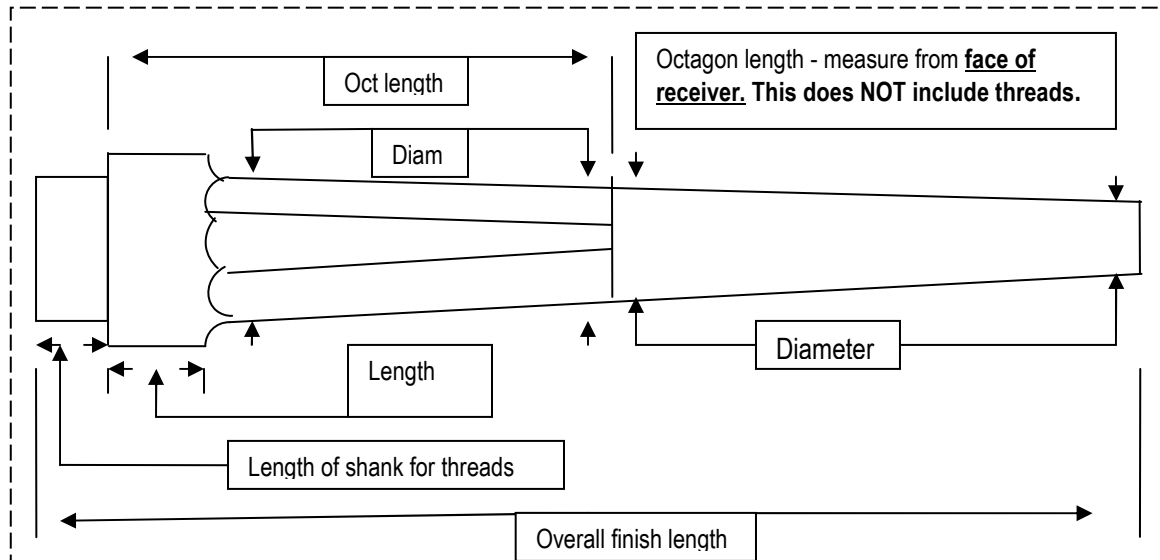

Barrel "E" like
Winchester
type full
octagon barrel

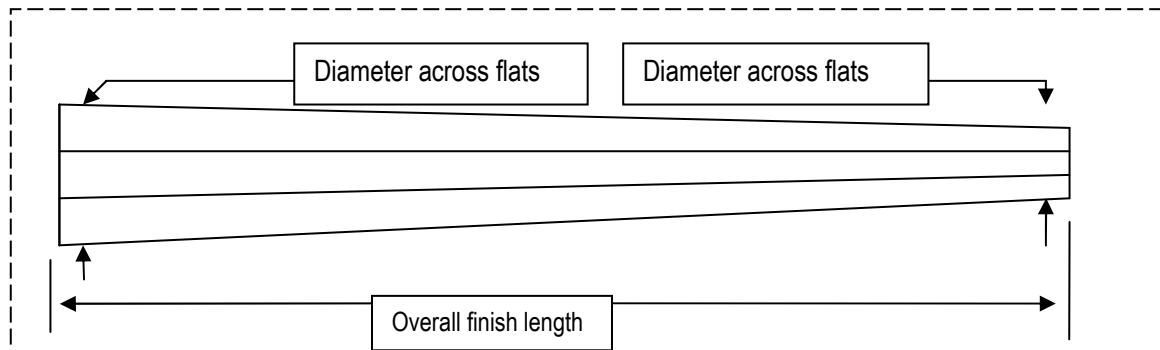

Barrel "E/C"
like
Winchester
type 1/2
octagon barrel

